

Workshop excerpt taken from the live webinar

Creating Realistic 3D Mock-ups with Adobe Stock and Dimension

Add a new perspective to your design work. See how your design translates to real-world objects by combining 3D models from Adobe Stock with custom decals in Dimension.



1. Download the following assets

Download the following image from Adobe Stock, and a logo file from Codify Design Studio.

Adobe Stock image: [Wooden board empty table...](#) by trichard
Logo File: [The Coffee House](#) by Codify Design Studio



2. Start with a free 3D model in Dimension

Open Adobe Dimension:

- Choose Create New from the Splash Screen
- Open the Models pane in the Starter Assets panel
- Click the Coffee Cup model to add it into the Scene

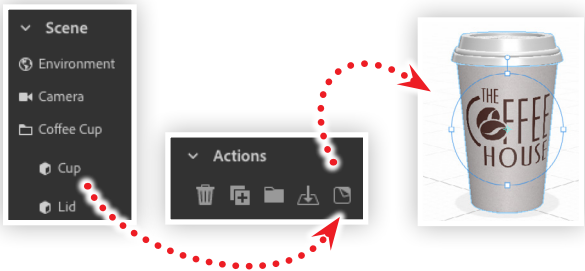

3. Apply a logo to the coffee cup

Click the folder icon for the Coffee Cup layer in the Scene panel:

- Select the cup object
- Click the Place Graphic on Model icon (📄) in the Actions panel
- Locate the Coffee House file from the Project Files and click Open
- Scale and position the logo on the surface of the cup

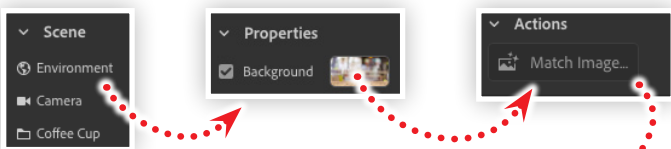

4. Add an environment to your scene

Apply an environmental image into your scene that can be used to adjust the perspective of your model.

- Select the Environment layer in the Scene panel
- Click the swatch for Background in the Properties panel
- Locate the Adobe Stock image of the wooden table
- Click the Match Image button in the Actions panel
- Check all of the options in the Match Image dialog box
- Click OK



Watch the webinar recording

Watch *Creating Realistic 3D Mock-ups with Adobe Stock and Dimension* in its entirety from the [Creative Cloud Events](#) page.

St Make it with Adobe Stock.